

# SW70-T Beltpack Transmitter Quick Setup Guide

## Opening Access Compartment

- 1 Press down firmly with both thumbs on battery door handle (above Sabine logo) and slide away from LCD.
- 2 Lift bottom edge of door slightly and continue pulling door down away from LCD until the door opens fully (90-degree angle from transmitter body).

## Closing Access Compartment

- 1 Swing door down, flush with transmitter body.
- 2 With both thumbs pressing firmly on door handle (above Sabine logo), slide door up toward LCD until door lip catches under main body of transmitter, and bottom of door is flush with bottom of transmitter body.

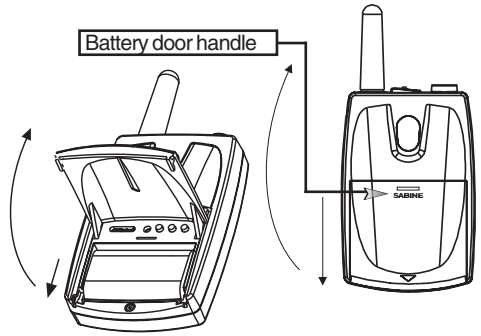

## Input Settings

Select either "MIC" or "GUI" for microphone or instrument.  
See Section 4.2.3 for details.

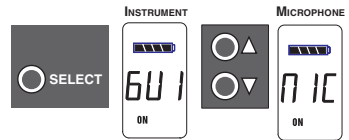

## PAD Settings

The SW70-T beltpack transmitter has a broad range of PAD settings, which allow you to use it with almost any microphone or instrument. As in all audio equipment, the setting of the input level is crucial to achieving the best sound quality. Setting minimal PAD levels (-3, -6, or -10 dB) may produce a distorted sound if you are using a high output microphone or instrument. Conversely, setting a more extreme PAD level (-40, -37, or -34 dB) may require you to raise your system gain unnecessarily, resulting in a noisier output. Watch the input meter on either the transmitter or the receiver (see illustrations) and set your level so there are at least three indicators illuminated for normal program level, with an occasional move to the fourth indicator. The fifth and biggest indicator denotes clipping – watch out! If you see clipping, choose a lower pad setting (for example, from -10 to -14 dB).

## Changing PAD Settings

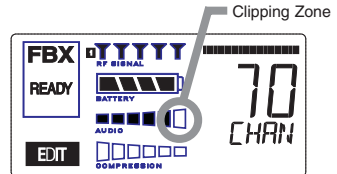
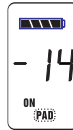
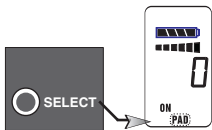

- 1 **Select PAD function:** Use the Transmitter Select button to scroll through functions until PAD flashes in the Transmitter LCD.
- 2 **Select PAD setting:** Use the Up or Down buttons to select the desired setting. Selection is stored after 3 seconds of inactivity.
- 3 **Check for Clipping:** Check to see if the receiver's Audio Level Meter stays out of the Clipping Zone.

## Suggested PAD Settings

Venue	PAD
Low output microphones	-10 dB
Standard mics & acoustic instruments with low-gain pickups (default setting)	-14 dB
Electric guitars with low-gain pickups & mics with higher gain	-20 dB
Most standard electric guitars	-26 or -30
Instruments with high-gain pre-amps	-34 dB

*Please carefully read the operating guide for complete instructions.*

# SW70-T Quick Guide Setup – Battery Information

## Important Battery Information

Your Sabine True Mobility® SW70-T backpack transmitter comes with two size AA rechargeable NiMH batteries. For best results, charge the battery for at least 8 hours before using it for the first time. Please note that the full charging potential of the battery will be achieved after the first 5 charging cycles have been completed.

These rechargeable NiMH batteries are highly resistant to the “memory effect,” which affects some rechargeable batteries. The included batteries will provide more lifetime charges and longer battery life for each charge than many rechargeable batteries.

### Acceptable Batteries for use with SW70-T Backpack Transmitters

#### SW70-T Backpack Transmitters

2 “AA” size (14.5x50.5mm, 単3電池2本使用)

- NiMH Rechargeable (Sabine part #: SWBAA2)
- Alkaline: NEDA 14A - ANSI 14A - IEC LR14
- Heavy Duty batteries (NOT recommended)

### WARNING! DO NOT USE: Alkaline Rechargeable Batteries

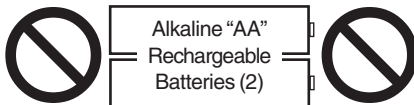

### Battery Caution



DO NOT BURN OR PUNCTURE BATTERY.  
DOING SO COULD RELEASE TOXIC MATERIALS WHICH COULD CAUSE INJURY.



DO NOT SHORT CIRCUIT.  
MUST BE RECYCLED OR DISPOSED OF PROPERLY.